

Belt oil separator. **BURAN**

General description:

The equipment is determined for removal of separated fats and oils from surface of metalworking liquids. Moreover, equipment is possible to apply in receivers with water solution, where separated fats and oils are necessary to remove from the level. Particular parts of the equipment are made out of materials, or surface treated materials in such way to bear up corrosion and bear up impact of oils. The equipment is not suitable for liquids containing alkali. The equipment is powered from source with safe voltage.

Description of parts:

- 1 Doctor blade, outlet part.
- 2 Mechanical bracket with thrust bolt for manual handling.
- 3 Connector 5.5x2.1 of low voltage 12V DC.
- 4 Separator body.
- 5 Switch and rotation speed regulator.
- 6 Oil distributor's logo.
- 7 Driven separator pulley.
- 8 Wiped belt with width of 80mm.
- 9 Tension pulley steely.
- 10 Liquid.

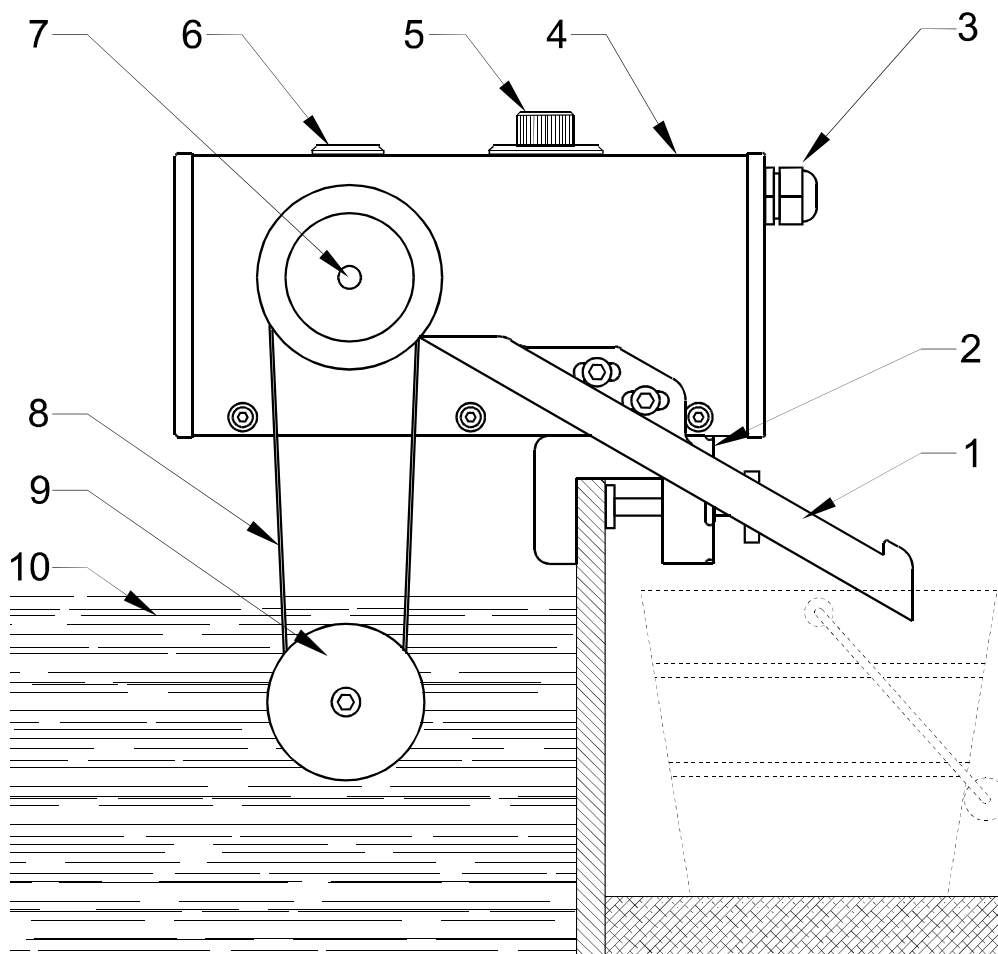

Technical specifications:

Supply voltage of the source - adapter:	AC- 230V / 50Hz
Supply voltage of the separator:	12V DC
Input power:	35 W
Weight:	2,5 kg
Liquid max. temperature:	80°C for the belt of PP
Regulation:	Continuous
Operation life of the wiped belt:	2,500 hours.
Consumable spare parts:	Wiped belt
Used materials:	Aluminium alloy AlMgSi, nickel-coated steel, PE, PP

Installation:

Prior installation see previous picture. First it is necessary to fix the separator body that the separator pulley (7) to be over level of liquid. We can fasten separator on the edge of the receiver, or on other flat support. Subsequently, it is necessary to put the belt (8) with tension pulley (9) on. Belt is to be installed through the pulley free of twist-off. Also, It is necessary to pay attention that the tension pulleys (9) should not touch bottom or side wall of the receiver. Moreover, it is necessary to plug the connector from attached adapter into the socket (3) on the separator body. Finally engage the net cord of the adapter into 230V, 50Hz socket. Prior start-up of the separator it is advisable to put the vessel for separated oil to the end of the scrapping part (1).

Operation:

The separator is switched on/off and controlled by means of the regulator (5). The scale, denoting function of regulator is placed under the regulator. In the "0" position the separator is switched off. Other positions of the controller serve for continuous speed regulation of the wiped belts. Performance of the separator i.e. quantity of separated oil per hour, depends on speed of wiped belts. At higher speed occurs higher discharge of the liquid from the tank. This attribute highly depends on kind of liquid and also on kind of separated greases.

It is possible to connect the device through switching clock, and in this way is possible to assure the service-free operation.

Maintenance and cleaning::

The separator is maintenance-free. At exchange of liquid in the tank is advisable to clean the pulley and belts with rollers. In case of failure please contact directly the manufacturer VAVVE Nitra or your supplier.

Warning:

- In case of failure disconnect the equipment out of el. power network by network cord pulling from network socket.
- During operation take care to prevent equipment against falling into liquid.
- During operation take care to prevent equipment against spilling by liquid.
- Do not place things on the separator, or its parts.
- During operation wear protective means, e.g.: protective gloves, projective clothing, and others, according to type of liquids.
- Observe also all regulations of "Occupational Safety" according to type of liquids.
- Dispose the equipment in special container intended for this purpose.